

BEGIN PROJECT TO 36 1/2 AVE NE STA 16+50				
LEGEND	ITEM NUMBER	DESCRIPTION	UNIT	ESTIMATED TOTAL
(NO LANDSCAPE QUANTITIES THIS SHEET)				

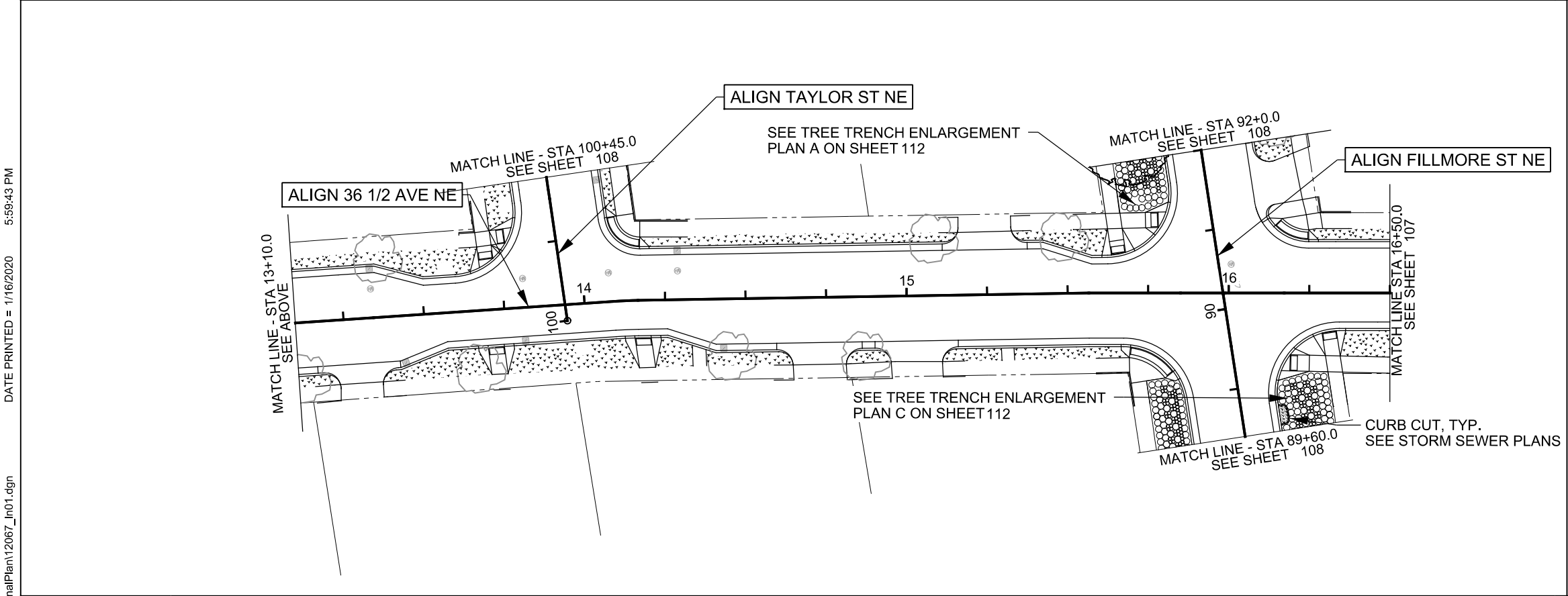

LEGEND

DECIDUOUS TREE

PERENNIAL PLANTINGS
SEE SHEETS 112 - 114

QUANTITY
PLANT SPECIES

EXISTING TREE
TO REMAIN

TREE TRENCH CURB CUT, TYP.
SEE STORM SEWER PLANS

SOD - SEE
CONSTR. PLANS

- LANDSCAPE GENERAL NOTES:
- THE CONTRACTOR SHALL VERIFY EXISTING CONDITIONS PRIOR TO BIDDING AND START OF CONSTRUCTION.
 - PROTECT ALL EXISTING STRUCTURES, UTILITIES, TREES, SITE AMENITIES, ETC. THAT ARE TO REMAIN.
 - RESTORE ALL TURF AREAS THAT ARE DISTURBED DURING CONSTRUCTION AND LANDSCAPE INSTALLATION.
 - SEE PLANT SCHEDULE ON SHEET 117.
 - CONTRACTOR SHALL COORDINATE LOCATION AND MARKING OF ALL UNDERGROUND UTILITIES ACCORDING TO STATE LAW PRIOR TO ANY WORK COMMENCING.
 - REPORT ALL LAYOUT DISCREPANCIES IMMEDIATELY TO THE LANDSCAPE ARCHITECT FOR DIRECTION PRIOR TO PROCEEDING.
 - CONTRACTOR TO STAKE ALL TREES AND PERENNIAL PLANTING BEDS PER PLAN AND ADJUST IF NECESSARY TO AVOID UTILITY CONFLICTS IN THE FIELD. LANDSCAPE ARCHITECT SHALL APPROVE LOCATIONS BEFORE PLANTING.
 - REFER TO PROJECT SPECIFICATIONS FOR ADDITIONAL REQUIREMENTS.

NO.	DATE	DRW	CKD	APP	REVISION

I HEREBY CERTIFY THAT THIS PLAN, SPECIFICATION, OR REPORT WAS PREPARED BY ME OR UNDER MY DIRECT SUPERVISION AND THAT I AM A DULY LICENSED PROFESSIONAL LANDSCAPE ARCHITECT UNDER THE LAWS OF THE STATE OF MINNESOTA.

SEAN C. JERGENS

47256

1/14/2020

LIC. NO.

DATE

LANDSCAPING PLANS

DRW: SCJ

DATE: 12/18/19

CHK: RB

DATE: 1/14/2020

APP: SCJ

DATE: 1/14/2020

HOYER HEIGHTS RECONSTRUCTION		106 OF 134
LP 600D2317	LP 600D4569	

FILE NAME = ...\\FinalPlan\\12067_in02.dgn
DATE PRINTED = 1/16/2020 5:59:45 PM

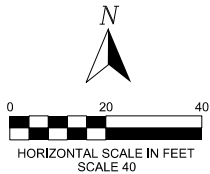
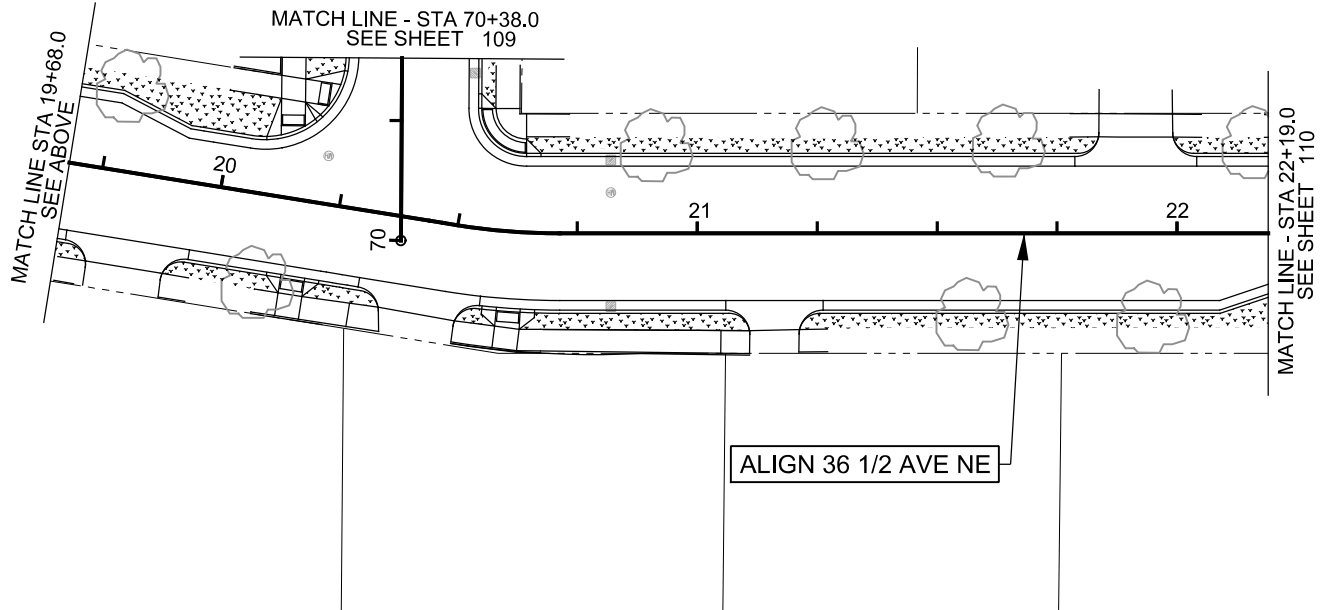
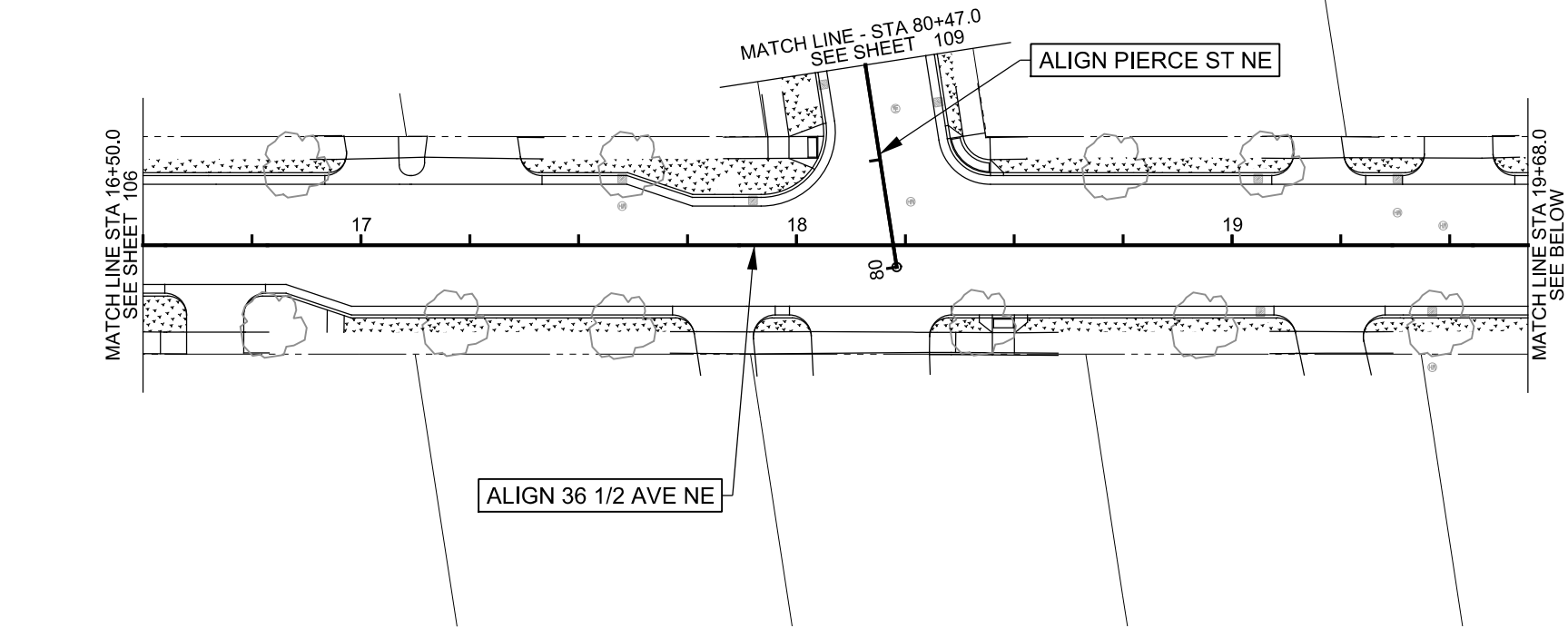
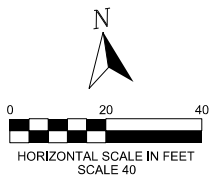

NO.	DATE	DRW	CKD	APP	REVISION

I HEREBY CERTIFY THAT THIS PLAN, SPECIFICATION, OR REPORT WAS PREPARED BY ME OR UNDER MY DIRECT SUPERVISION AND THAT I AM A DULY LICENSED PROFESSIONAL LANDSCAPE ARCHITECT UNDER THE LAWS OF THE STATE OF MINNESOTA.

Sean C. Jergens
SEAN C. JERGENS

47256 1/14/2020
LIC. NO. DATE



LANDSCAPING PLANS

DRW: SCJ	DATE: 12/18/19
CHK: RB	DATE: 1/14/2020
APP: SCJ	DATE: 1/14/2020

HOYER HEIGHTS RECONSTRUCTION

LP 600D2317 LP 600D4569

36 1/2 AVE NE STA 16+50 TO STA 22+19

LEGEND	ITEM NUMBER	DESCRIPTION	UNIT	ESTIMATED TOTAL
		(NO LANDSCAPE QUANTITIES THIS SHEET)		

LEGEND

	DECIDUOUS TREE		PERENNIAL PLANTINGS SEE SHEETS 112 - 114
	QUANTITY PLANT SPECIES		EXISTING TREE TO REMAIN
	TREE TRENCH CURB CUT, TYP. SEE STORM SEWER PLANS		SOD - SEE CONSTR. PLANS

LANDSCAPE GENERAL NOTES:

1. THE CONTRACTOR SHALL VERIFY EXISTING CONDITIONS PRIOR TO BIDDING AND START OF CONSTRUCTION.
2. PROTECT ALL EXISTING STRUCTURES, UTILITIES, TREES, SITE AMENITIES, ETC. THAT ARE TO REMAIN.
3. RESTORE ALL TURF AREAS THAT ARE DISTURBED DURING CONSTRUCTION AND LANDSCAPE INSTALLATION.
4. SEE PLANT SCHEDULE ON SHEET 117.
5. CONTRACTOR SHALL COORDINATE LOCATION AND MARKING OF ALL UNDERGROUND UTILITIES ACCORDING TO STATE LAW PRIOR TO ANY WORK COMMENCING.
6. REPORT ALL LAYOUT DISCREPANCIES IMMEDIATELY TO THE LANDSCAPE ARCHITECT FOR DIRECTION PRIOR TO PROCEEDING.
7. CONTRACTOR TO STAKE ALL TREES AND PERENNIAL PLANTING BEDS PER PLAN AND ADJUST IF NECESSARY TO AVOID UTILITY CONFLICTS IN THE FIELD. LANDSCAPE ARCHITECT SHALL APPROVE LOCATIONS BEFORE PLANTING.
8. REFER TO PROJECT SPECIFICATIONS FOR ADDITIONAL REQUIREMENTS.

FILE NAME = ...\\FinalPlan\\12067_in03.dgn
DATE PRINTED = 1/16/2020 5:59:47 PM

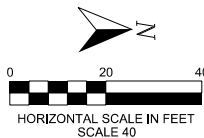
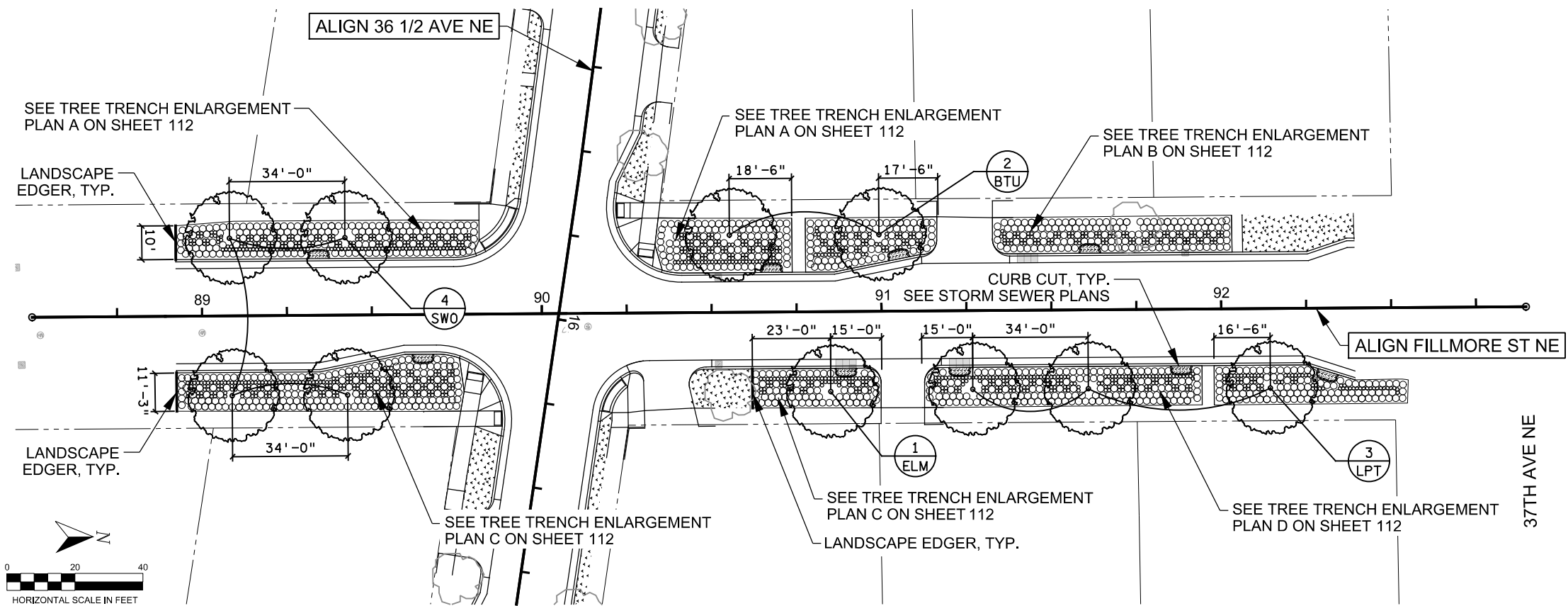
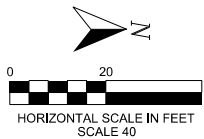



TAYLOR ST NE & FILLMORE STREET NE: SOUTH END TO STA 89+60.0, STA 90+83.0 NORTH END				
LEGEND	ITEM NUMBER	DESCRIPTION	UNIT	ESTIMATED TOTAL
N/A	2540.524	LANDSCAPE EDGER	LIN FT	32
N/A	2571.524	DECIDUOUS TREE 2.5" CAL B&B	TREE	10

LEGEND

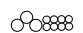
 DECIDUOUS TREE

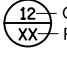
 PERENNIAL PLANTINGS
SEE SHEETS 112 - 114

 QUANTITY
PLANT SPECIES

 EXISTING TREE
TO REMAIN

 TREE TRENCH CURB CUT, TYP.
SEE STORM SEWER PLANS

 SOD - SEE
CONSTR. PLANS

- LANDSCAPE GENERAL NOTES:
1. THE CONTRACTOR SHALL VERIFY EXISTING CONDITIONS PRIOR TO BIDDING AND START OF CONSTRUCTION.
 2. PROTECT ALL EXISTING STRUCTURES, UTILITIES, TREES, SITE AMENITIES, ETC. THAT ARE TO REMAIN.
 3. RESTORE ALL TURF AREAS THAT ARE DISTURBED DURING CONSTRUCTION AND LANDSCAPE INSTALLATION.
 4. SEE PLANT SCHEDULE ON SHEET 117.
 5. CONTRACTOR SHALL COORDINATE LOCATION AND MARKING OF ALL UNDERGROUND UTILITIES ACCORDING TO STATE LAW PRIOR TO ANY WORK COMMENCING.
 6. REPORT ALL LAYOUT DISCREPANCIES IMMEDIATELY TO THE LANDSCAPE ARCHITECT FOR DIRECTION PRIOR TO PROCEEDING.
 7. CONTRACTOR TO STAKE ALL TREES AND PERENNIAL PLANTING BEDS PER PLAN AND ADJUST IF NECESSARY TO AVOID UTILITY CONFLICTS IN THE FIELD. LANDSCAPE ARCHITECT SHALL APPROVE LOCATIONS BEFORE PLANTING.
 8. REFER TO PROJECT SPECIFICATIONS FOR ADDITIONAL REQUIREMENTS.



NO.	DATE	DRW	CKD	APP	REVISION

I HEREBY CERTIFY THAT THIS PLAN, SPECIFICATION, OR REPORT WAS PREPARED BY ME OR UNDER MY DIRECT SUPERVISION AND THAT I AM A DULY LICENSED PROFESSIONAL LANDSCAPE ARCHITECT UNDER THE LAWS OF THE STATE OF MINNESOTA.

SEAN C. JERGENS

47256
LIC. NO.

1/14/2020
DATE



LANDSCAPING PLANS

DRW: SCJ
CHK: RB
APP: SCJ

DATE: 12/18/19
DATE: 1/14/2020
DATE: 1/14/2020

HOYER HEIGHTS RECONSTRUCTION		108 OF 134
LP 600D2317	LP 600D4569	

FILE NAME = ...\\FinalPlan\\12067_in04.dgn
DATE PRINTED = 1/16/2020 5:59:49 PM

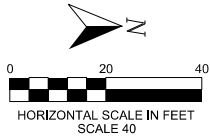

MATCH LINE - STA 80+47.0
SEE SHEET 107

ALIGN PIERCE ST NE

81

82

83

37TH AVE NE

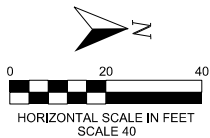

MATCH LINE - STA 70+38.0
SEE SHEET 107

ALIGN PIERCE PL NE

71

72

73

37TH AVE NE

PIERCE ST NE & PIERCE PL NE

LEGEND	ITEM NUMBER	DESCRIPTION	UNIT	ESTIMATED TOTAL
		(NO LANDSCAPE QUANTITIES THIS SHEET)		

LEGEND



DECIDUOUS TREE



PERENNIAL PLANTINGS
SEE SHEETS 112 - 114



QUANTITY
PLANT SPECIES



EXISTING TREE
TO REMAIN



TREE TRENCH CURB CUT, TYP.
SEE STORM SEWER PLANS



SOD - SEE
CONSTR. PLANS

LANDSCAPE GENERAL NOTES:

1. THE CONTRACTOR SHALL VERIFY EXISTING CONDITIONS PRIOR TO BIDDING AND START OF CONSTRUCTION.
2. PROTECT ALL EXISTING STRUCTURES, UTILITIES, TREES, SITE AMENITIES, ETC. THAT ARE TO REMAIN.
3. RESTORE ALL TURF AREAS THAT ARE DISTURBED DURING CONSTRUCTION AND LANDSCAPE INSTALLATION.
4. SEE PLANT SCHEDULE ON SHEET 117.
5. CONTRACTOR SHALL COORDINATE LOCATION AND MARKING OF ALL UNDERGROUND UTILITIES ACCORDING TO STATE LAW PRIOR TO ANY WORK COMMENCING.
6. REPORT ALL LAYOUT DISCREPANCIES IMMEDIATELY TO THE LANDSCAPE ARCHITECT FOR DIRECTION PRIOR TO PROCEEDING.
7. CONTRACTOR TO STAKE ALL TREES AND PERENNIAL PLANTING BEDS PER PLAN AND ADJUST IF NECESSARY TO AVOID UTILITY CONFLICTS IN THE FIELD. LANDSCAPE ARCHITECT SHALL APPROVE LOCATIONS BEFORE PLANTING.
8. REFER TO PROJECT SPECIFICATIONS FOR ADDITIONAL REQUIREMENTS.

NO.	DATE	DRW	CKD	APP	REVISION

I HEREBY CERTIFY THAT THIS PLAN, SPECIFICATION, OR REPORT WAS PREPARED BY ME OR UNDER MY DIRECT SUPERVISION AND THAT I AM A DULY LICENSED PROFESSIONAL LANDSCAPE ARCHITECT UNDER THE LAWS OF THE STATE OF MINNESOTA.

Sean C. Jergens
SEAN C. JERGENS

47256 1/14/2020
LIC. NO. DATE



LANDSCAPING PLANS

DRW: SCJ	DATE: 12/18/19
CHK: RB	DATE: 1/14/2020
APP: SCJ	DATE: 1/14/2020

HOYER HEIGHTS RECONSTRUCTION

LP 600D2317 LP 600D4569

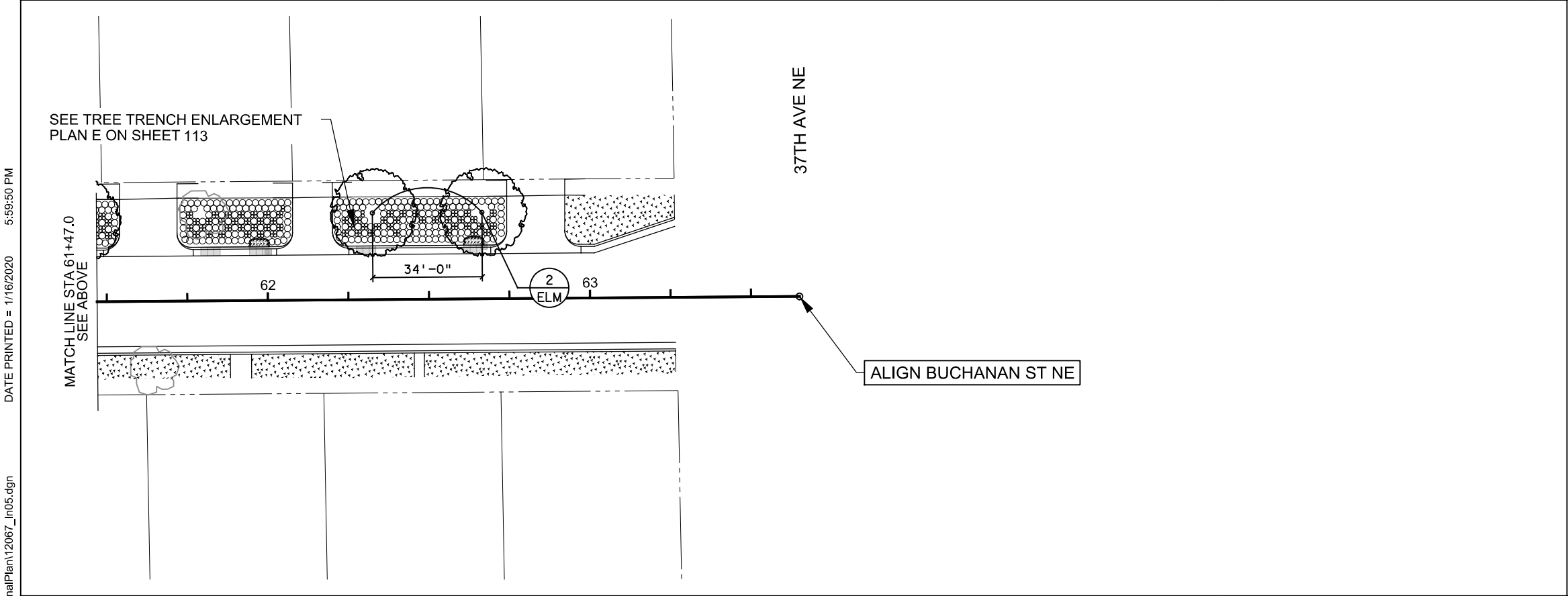
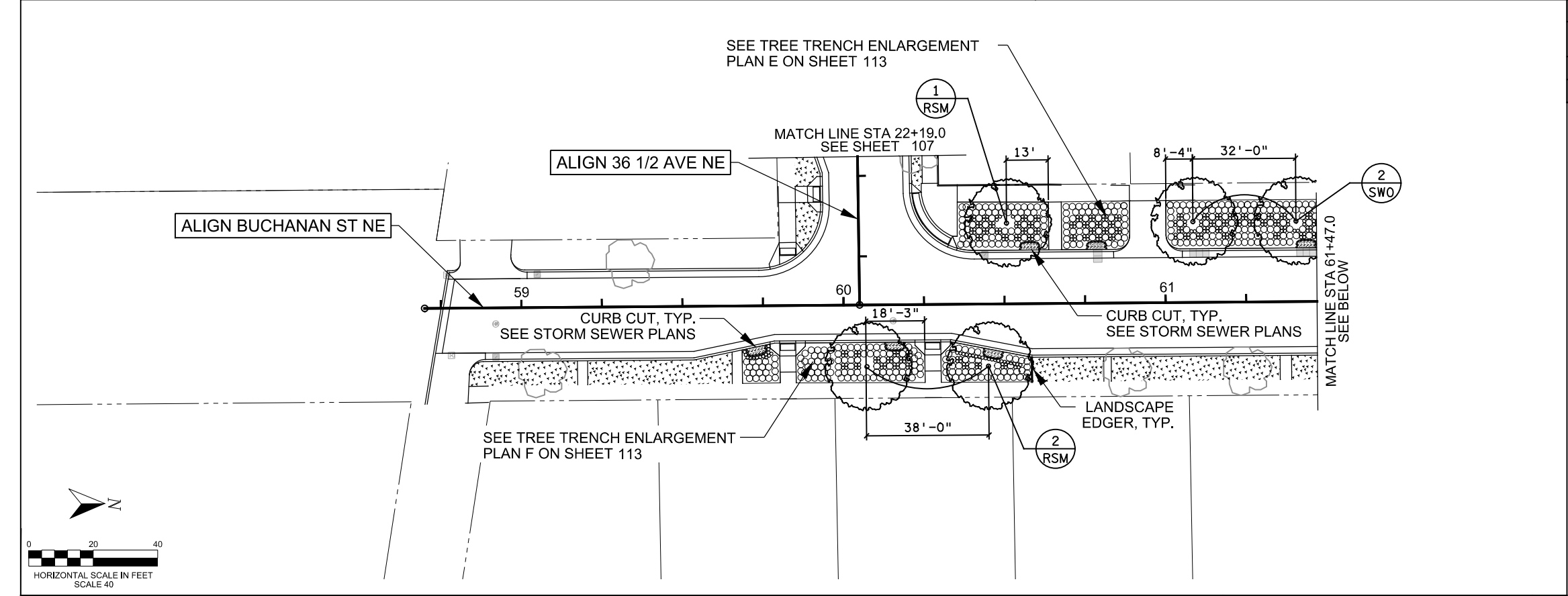

BUCHANAN ST NE				
LEGEND	ITEM NUMBER	DESCRIPTION	UNIT	ESTIMATED TOTAL
N/A	2540.603	LANDSCAPE EDGER	LIN FT	8
N/A	2571.524	DECIDUOUS TREE	TREE	5

LEGEND

DECIDUOUS TREE

PERENNIAL PLANTINGS
SEE SHEETS 112 - 114

QUANTITY
PLANT SPECIES

EXISTING TREE
TO REMAIN

TREE TRENCH CURB CUT, TYP.
SEE STORM SEWER PLANS

SOD - SEE
CONSTR. PLANS

- LANDSCAPE GENERAL NOTES:**
1. THE CONTRACTOR SHALL VERIFY EXISTING CONDITIONS PRIOR TO BIDDING AND START OF CONSTRUCTION.
 2. PROTECT ALL EXISTING STRUCTURES, UTILITIES, TREES, SITE AMENITIES, ETC. THAT ARE TO REMAIN.
 3. RESTORE ALL TURF AREAS THAT ARE DISTURBED DURING CONSTRUCTION AND LANDSCAPE INSTALLATION.
 4. SEE PLANT SCHEDULE ON SHEET 117.
 5. CONTRACTOR SHALL COORDINATE LOCATION AND MARKING OF ALL UNDERGROUND UTILITIES ACCORDING TO STATE LAW PRIOR TO ANY WORK COMMENCING.
 6. REPORT ALL LAYOUT DISCREPANCIES IMMEDIATELY TO THE LANDSCAPE ARCHITECT FOR DIRECTION PRIOR TO PROCEEDING.
 7. CONTRACTOR TO STAKE ALL TREES AND PERENNIAL PLANTING BEDS PER PLAN AND ADJUST IF NECESSARY TO AVOID UTILITY CONFLICTS IN THE FIELD. LANDSCAPE ARCHITECT SHALL APPROVE LOCATIONS BEFORE PLANTING.
 8. REFER TO PROJECT SPECIFICATIONS FOR ADDITIONAL REQUIREMENTS.

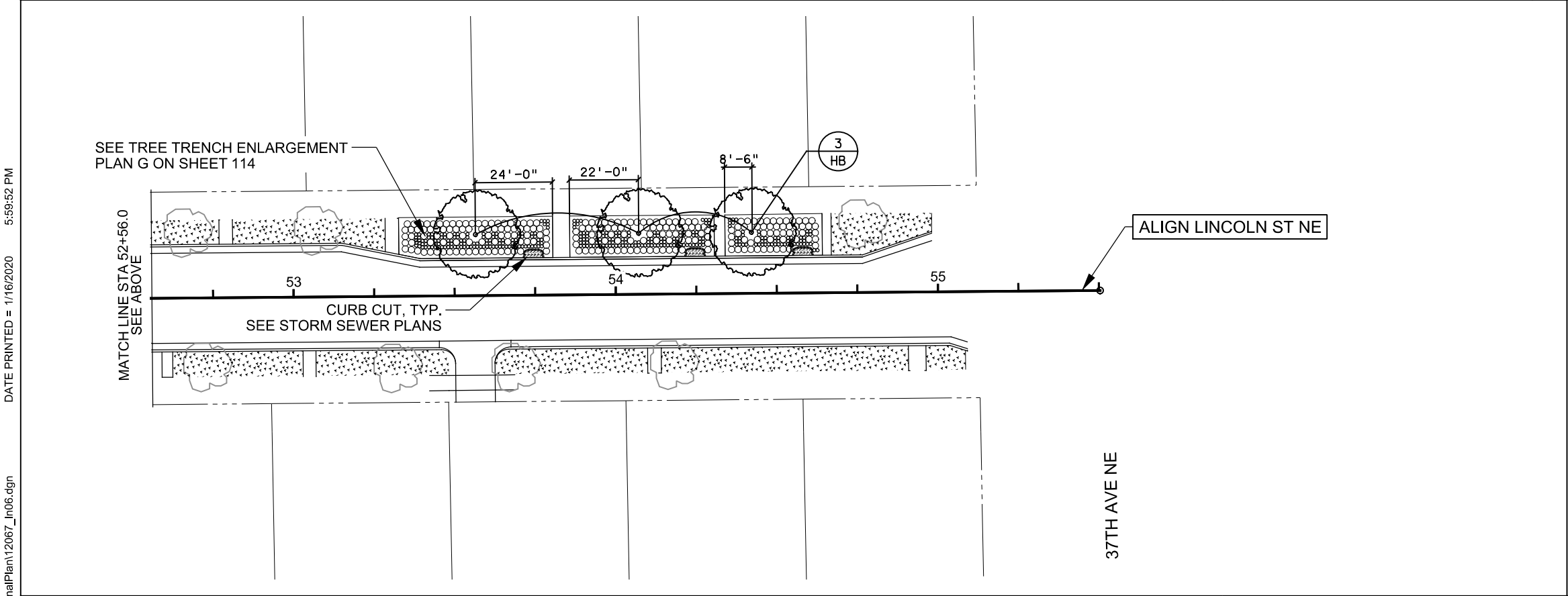
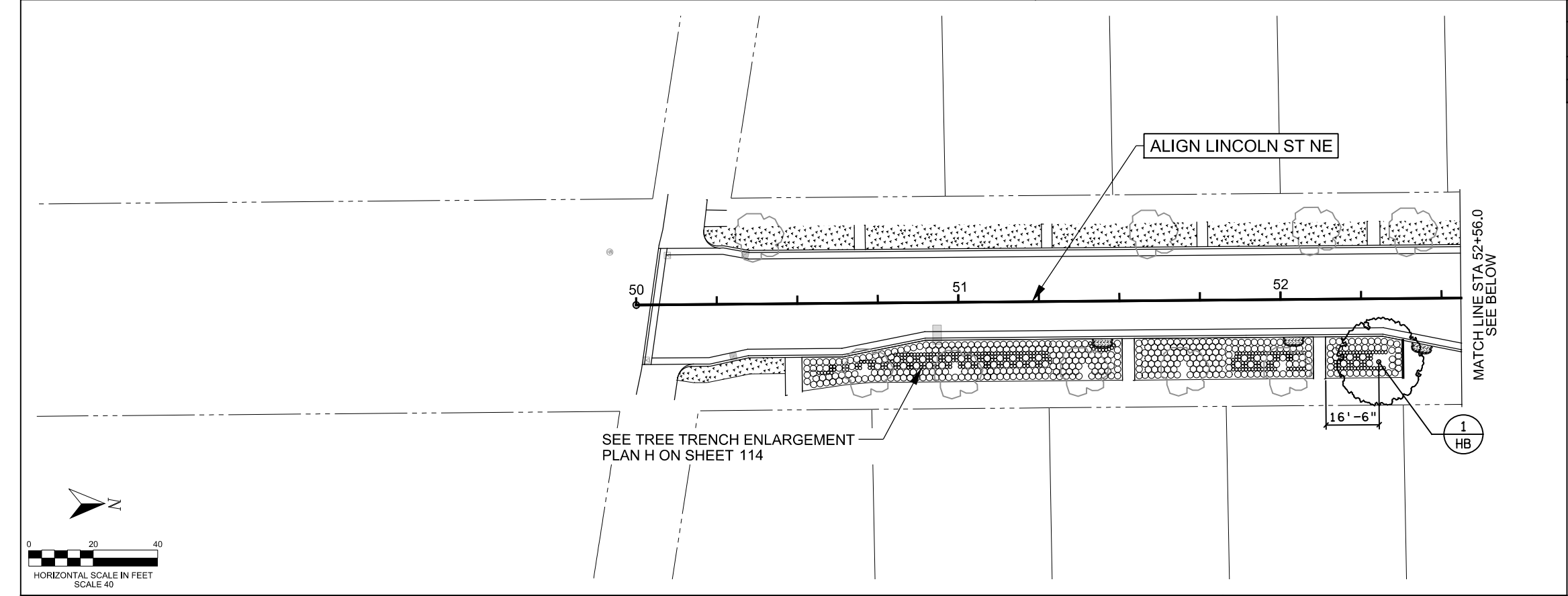

BUCHANAN ST NE				
LEGEND	ITEM NUMBER	DESCRIPTION	UNIT	ESTIMATED TOTAL
N/A	2540.603	LANDSCAPE EDGER	LIN FT	12
N/A	2571.524	DECIDUOUS TREE	TREE	4

LEGEND			
	DECIDUOUS TREE		PERENNIAL PLANTINGS SEE SHEETS 112 - 114
	QUANTITY PLANT SPECIES		EXISTING TREE TO REMAIN
	TREE TRENCH CURB CUT, TYP. SEE STORM SEWER PLANS		SOD - SEE CONSTR. PLANS

LANDSCAPE GENERAL NOTES:

1. THE CONTRACTOR SHALL VERIFY EXISTING CONDITIONS PRIOR TO BIDDING AND START OF CONSTRUCTION.
2. PROTECT ALL EXISTING STRUCTURES, UTILITIES, TREES, SITE AMENITIES, ETC. THAT ARE TO REMAIN.
3. RESTORE ALL TURF AREAS THAT ARE DISTURBED DURING CONSTRUCTION AND LANDSCAPE INSTALLATION.
4. SEE PLANT SCHEDULE ON SHEET 117.
5. CONTRACTOR SHALL COORDINATE LOCATION AND MARKING OF ALL UNDERGROUND UTILITIES ACCORDING TO STATE LAW PRIOR TO ANY WORK COMMENCING.
6. REPORT ALL LAYOUT DISCREPANCIES IMMEDIATELY TO THE LANDSCAPE ARCHITECT FOR DIRECTION PRIOR TO PROCEEDING.
7. CONTRACTOR TO STAKE ALL TREES AND PERENNIAL PLANTING BEDS PER PLAN AND ADJUST IF NECESSARY TO AVOID UTILITY CONFLICTS IN THE FIELD. LANDSCAPE ARCHITECT SHALL APPROVE LOCATIONS BEFORE PLANTING.
8. REFER TO PROJECT SPECIFICATIONS FOR ADDITIONAL REQUIREMENTS.

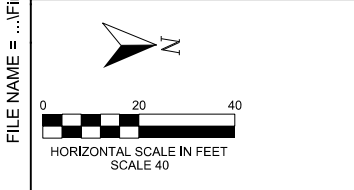

NO.	DATE	DRW	CKD	APP	REVISION

I HEREBY CERTIFY THAT THIS PLAN, SPECIFICATION, OR REPORT WAS PREPARED BY ME OR UNDER MY DIRECT SUPERVISION AND THAT I AM A DULY LICENSED PROFESSIONAL LANDSCAPE ARCHITECT UNDER THE LAWS OF THE STATE OF MINNESOTA.

Sean C. Jergens
SEAN C. JERGENS

47256
LIC. NO.

1/14/2020
DATE

LANDSCAPING PLANS

DRW: SCJ	DATE: 12/18/19
CHK: RB	DATE: 1/14/2020
APP: SCJ	DATE: 1/14/2020

HOYER HEIGHTS RECONSTRUCTION

LP 600D2317	LP 600D4569
-------------	-------------

111
OF
134

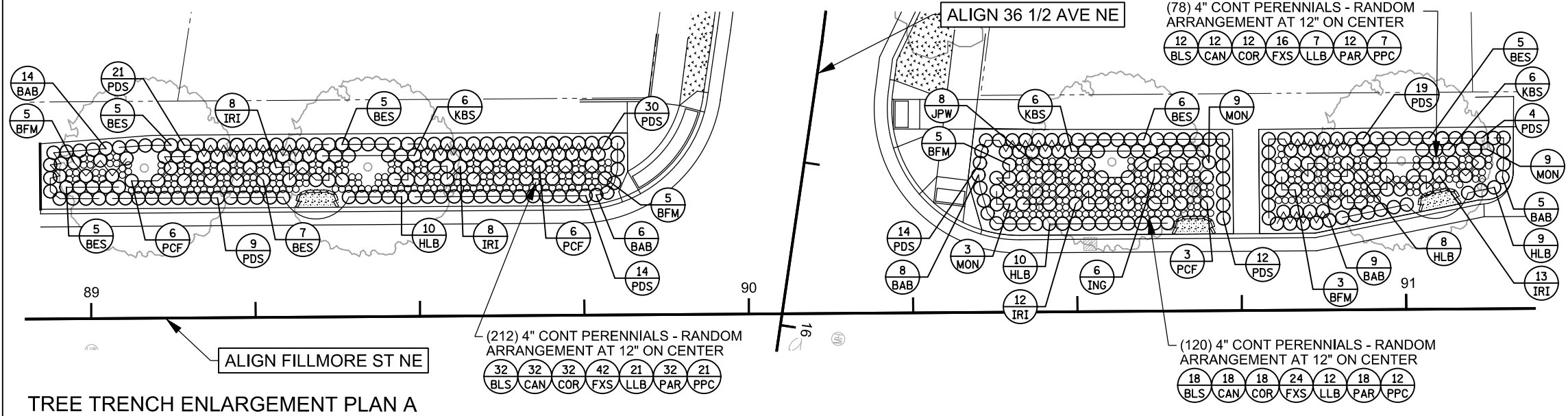

FILLMORE STREET NE				
LEGEND	ITEM NUMBER	DESCRIPTION	UNIT	ESTIMATED TOTAL
N/A	2571.527	PERENNIAL 4" CONT	PLANT	1097
N/A	2571.527	PERENNIAL NO 1 CONT	PLANT	1017

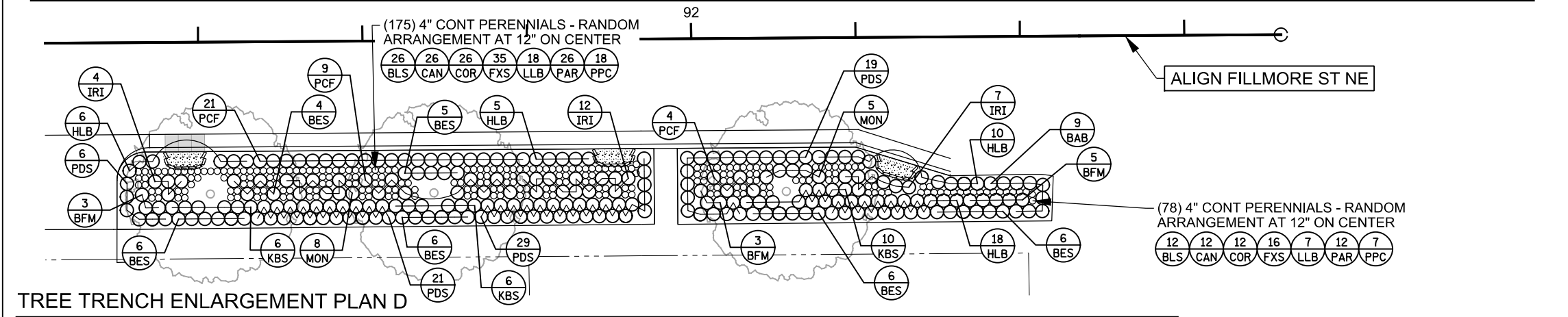
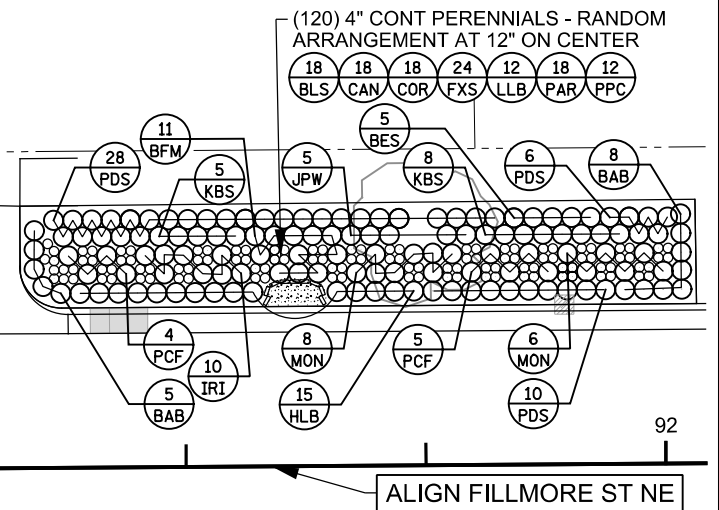
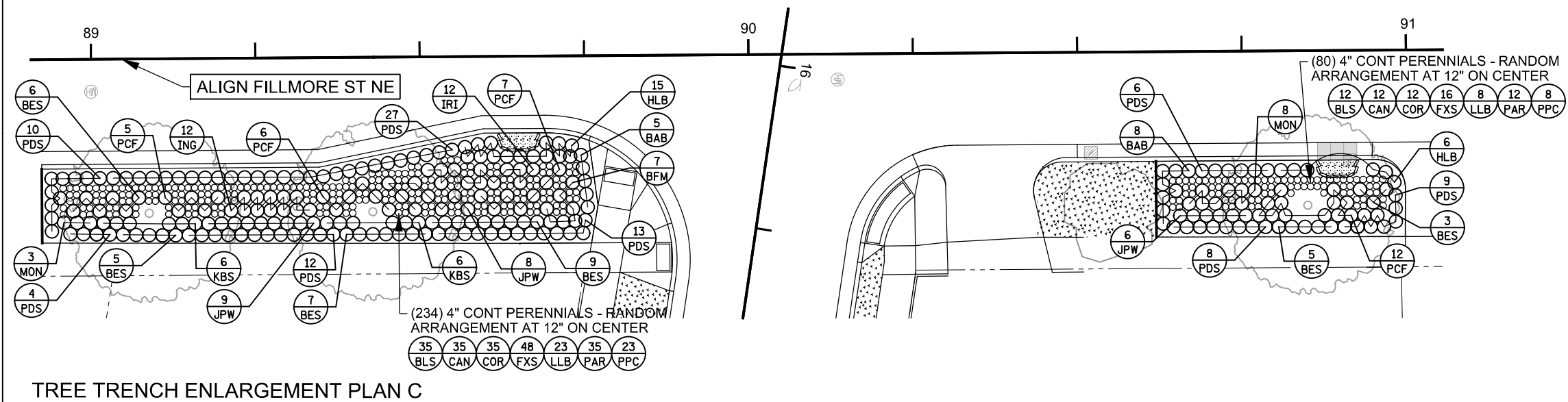
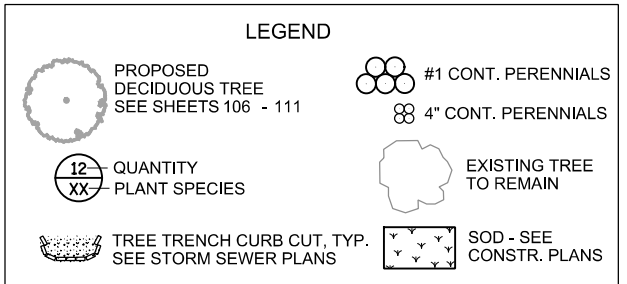

TREE TRENCH ENLARGEMENT PLAN B

LANDSCAPE GENERAL NOTES:

1. THE CONTRACTOR SHALL VERIFY EXISTING CONDITIONS PRIOR TO BIDDING AND START OF CONSTRUCTION.
2. PROTECT ALL EXISTING STRUCTURES, UTILITIES, TREES, SITE AMENITIES, ETC. THAT ARE TO REMAIN.
3. RESTORE ALL TURF AREAS THAT ARE DISTURBED DURING CONSTRUCTION AND LANDSCAPE INSTALLATION.
4. SEE PLANT SCHEDULE ON SHEET 117.
5. CONTRACTOR SHALL COORDINATE LOCATION AND MARKING OF ALL UNDERGROUND UTILITIES ACCORDING TO STATE LAW PRIOR TO ANY WORK COMMENCING.
6. REPORT ALL LAYOUT DISCREPANCIES IMMEDIATELY TO THE LANDSCAPE ARCHITECT FOR DIRECTION PRIOR TO PROCEEDING.
7. CONTRACTOR TO STAKE ALL TREES AND PERENNIAL PLANTING BEDS PER PLAN AND ADJUST IF NECESSARY TO AVOID UTILITY CONFLICTS IN THE FIELD. LANDSCAPE ARCHITECT SHALL APPROVE LOCATIONS BEFORE PLANTING.
8. REFER TO PROJECT SPECIFICATIONS FOR ADDITIONAL REQUIREMENTS.

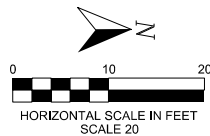

NO.	DATE	DRW	CKD	APP	REVISION

I HEREBY CERTIFY THAT THIS PLAN, SPECIFICATION, OR REPORT WAS PREPARED BY ME OR UNDER MY DIRECT SUPERVISION AND THAT I AM A DULY LICENSED PROFESSIONAL LANDSCAPE ARCHITECT UNDER THE LAWS OF THE STATE OF MINNESOTA.

 47256 1/14/2020

SEAN C. JERGENS LIC. NO. DATE



Minneapolis
Public Works

LANDSCAPE PLANS

DRW: SCJ	DATE: 12/18/19
CHK: RB	DATE: 1/14/2020
APP: SCJ	DATE: 1/14/2020

HOYER HEIGHTS RECONSTRUCTION

LP 600D2317 LP 600D4569

12
OF
34

BUCHANAN STREET NE				
LEGEND	ITEM NUMBER	DESCRIPTION	UNIT	ESTIMATED TOTAL
N/A	2571.527	PERENNIAL 4" CONT	PLANT	616
N/A	2571.527	PERENNIAL NO 1 CONT	PLANT	631

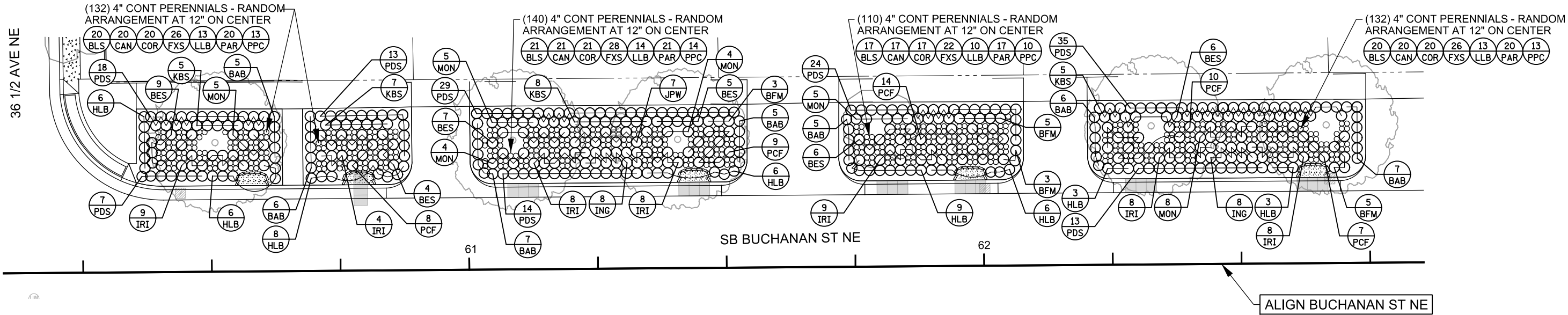

TREE TRENCH ENLARGEMENT PLAN E

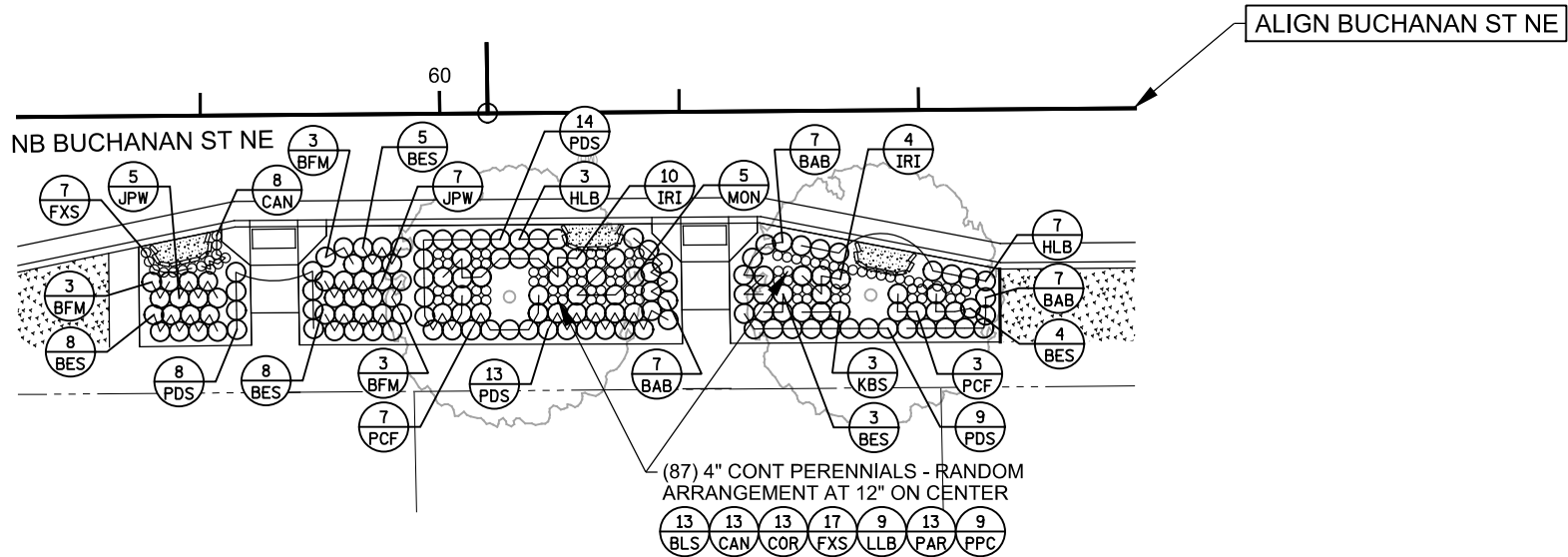

TREE TRENCH ENLARGEMENT PLAN F

LEGEND

- PROPOSED DECIDUOUS TREE SEE SHEETS 106 - 111
- #1 CONT. PERENNIALS
- 4" CONT. PERENNIALS
- QUANTITY PLANT SPECIES
- EXISTING TREE TO REMAIN
- TREE TRENCH CURB CUT, TYP. SEE STORM SEWER PLANS
- SOD - SEE CONSTR. PLANS

- LANDSCAPE GENERAL NOTES:**
- THE CONTRACTOR SHALL VERIFY EXISTING CONDITIONS PRIOR TO BIDDING AND START OF CONSTRUCTION.
 - PROTECT ALL EXISTING STRUCTURES, UTILITIES, TREES, SITE AMENITIES, ETC. THAT ARE TO REMAIN.
 - RESTORE ALL TURF AREAS THAT ARE DISTURBED DURING CONSTRUCTION AND LANDSCAPE INSTALLATION.
 - SEE PLANT SCHEDULE ON SHEET 117.
 - CONTRACTOR SHALL COORDINATE LOCATION AND MARKING OF ALL UNDERGROUND UTILITIES ACCORDING TO STATE LAW PRIOR TO ANY WORK COMMENCING.
 - REPORT ALL LAYOUT DISCREPANCIES IMMEDIATELY TO THE LANDSCAPE ARCHITECT FOR DIRECTION PRIOR TO PROCEEDING.
 - CONTRACTOR TO STAKE ALL TREES AND PERENNIAL PLANTING BEDS PER PLAN AND ADJUST IF NECESSARY TO AVOID UTILITY CONFLICTS IN THE FIELD. LANDSCAPE ARCHITECT SHALL APPROVE LOCATIONS BEFORE PLANTING.
 - REFER TO PROJECT SPECIFICATIONS FOR ADDITIONAL REQUIREMENTS.

NO.	DATE	DRW	CKD	APP	REVISION

I HEREBY CERTIFY THAT THIS PLAN, SPECIFICATION, OR REPORT WAS PREPARED BY ME OR UNDER MY DIRECT SUPERVISION AND THAT I AM A DULY LICENSED PROFESSIONAL LANDSCAPE ARCHITECT UNDER THE LAWS OF THE STATE OF MINNESOTA.

Sean C. Jergens

SEAN C. JERGENS

47256 1/14/2020

LIC. NO. DATE

LANDSCAPE PLANS

DRW: SCJ	DATE: 12/18/19
CHK: RB	DATE: 1/14/2020
APP: SCJ	DATE: 1/14/2020

HOYER HEIGHTS RECONSTRUCTION

LP 600D2317	LP 600D4569
-------------	-------------

113 OF 134

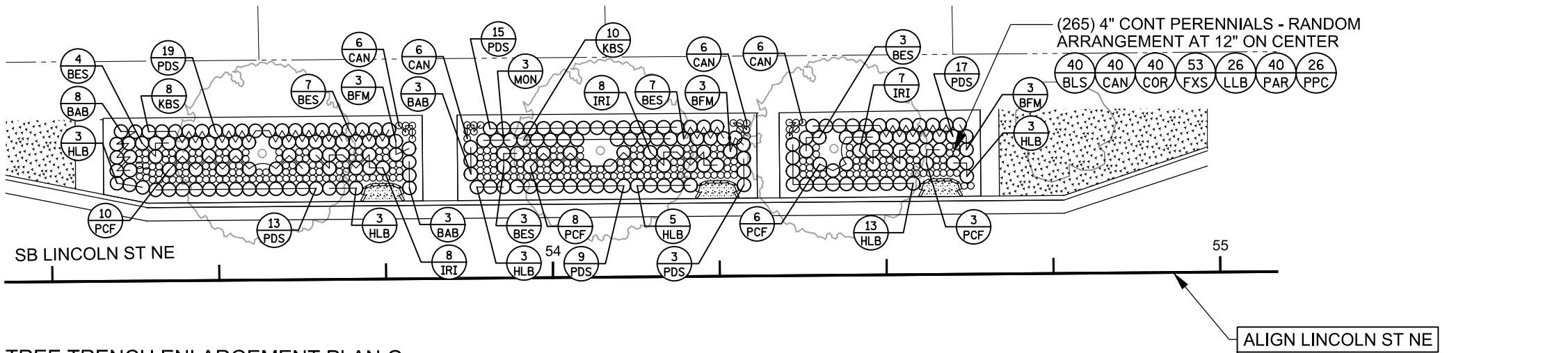

TREE TRENCH ENLARGEMENT PLAN G

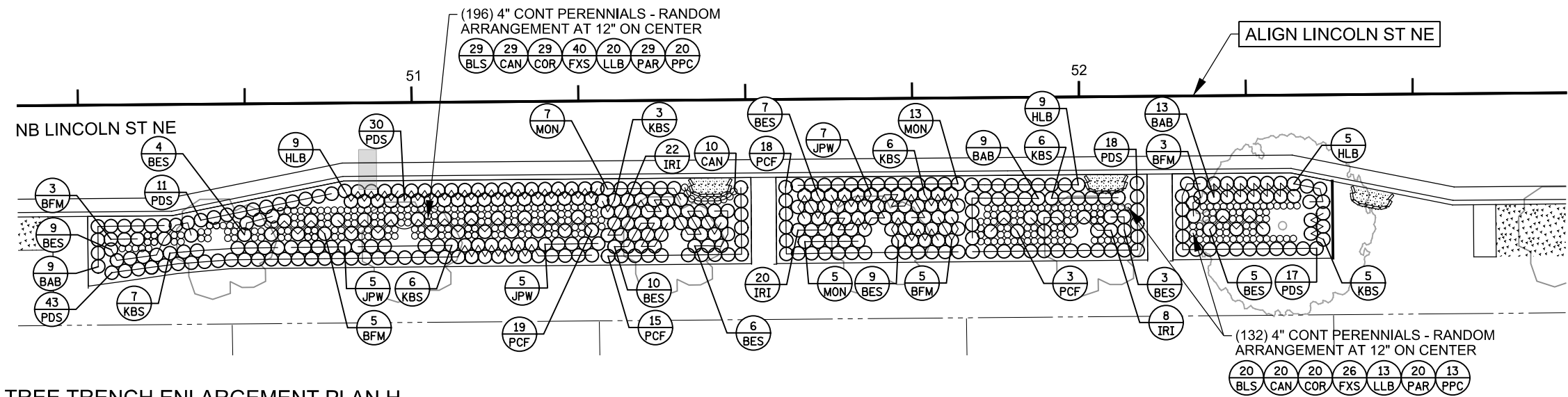

TREE TRENCH ENLARGEMENT PLAN H

LINCOLN STREET NE				
LEGEND	ITEM NUMBER	DESCRIPTION	UNIT	ESTIMATED TOTAL
N/A	2571.527	PERENNIAL 4" CONT	PLANT	627
N/A	2571.527	PERENNIAL NO 1 CONT	PLANT	657

LEGEND	
	PROPOSED DECIDUOUS TREE SEE SHEETS 106 - 111
	QUANTITY PLANT SPECIES
	TREE TRENCH CURB CUT, TYP. SEE STORM SEWER PLANS
	#1 CONT. PERENNIALS
	4" CONT. PERENNIALS
	EXISTING TREE TO REMAIN
	SOD - SEE CONSTR. PLANS

LANDSCAPE GENERAL NOTES:

1. THE CONTRACTOR SHALL VERIFY EXISTING CONDITIONS PRIOR TO BIDDING AND START OF CONSTRUCTION.
2. PROTECT ALL EXISTING STRUCTURES, UTILITIES, TREES, SITE AMENITIES, ETC. THAT ARE TO REMAIN.
3. RESTORE ALL TURF AREAS THAT ARE DISTURBED DURING CONSTRUCTION AND LANDSCAPE INSTALLATION.
4. SEE PLANT SCHEDULE ON SHEET 117.
5. CONTRACTOR SHALL COORDINATE LOCATION AND MARKING OF ALL UNDERGROUND UTILITIES ACCORDING TO STATE LAW PRIOR TO ANY WORK COMMENCING.
6. REPORT ALL LAYOUT DISCREPANCIES IMMEDIATELY TO THE LANDSCAPE ARCHITECT FOR DIRECTION PRIOR TO PROCEEDING.
7. CONTRACTOR TO STAKE ALL TREES AND PERENNIAL PLANTING BEDS PER PLAN AND ADJUST IF NECESSARY TO AVOID UTILITY CONFLICTS IN THE FIELD. LANDSCAPE ARCHITECT SHALL APPROVE LOCATIONS BEFORE PLANTING.
8. REFER TO PROJECT SPECIFICATIONS FOR ADDITIONAL REQUIREMENTS.

HORIZONTAL SCALE IN FEET
SCALE 20

NO.	DATE	DRW	CKD	APP	REVISION

I HEREBY CERTIFY THAT THIS PLAN, SPECIFICATION, OR REPORT WAS PREPARED BY ME OR UNDER MY DIRECT SUPERVISION AND THAT I AM A DULY LICENSED PROFESSIONAL LANDSCAPE ARCHITECT UNDER THE LAWS OF THE STATE OF MINNESOTA.

SEAN C. JERGENS

47256

1/14/2020

LIC. NO. DATE

LANDSCAPE PLANS	
DRW: SCJ	DATE: 12/18/19
CHK: RB	DATE: 1/14/2020
APP: SCJ	DATE: 1/14/2020

HOYER HEIGHTS RECONSTRUCTION	
LP 600D2317	LP 600D4569

114
OF
134

GENERAL NOTES		
SEE SPECIAL PROVISIONS FOR SPECIFIC PROJECT REQUIREMENTS.		
REFER TO MnDOT SPECIFICATIONS 2571, 3861, AND THE "2019 INSPECTION AND CONTRACT ADMINISTRATION MANUAL FOR MnDOT LANDSCAPE PROJECTS" FOR GENERAL REQUIREMENTS.		
COMPLETE PREPARATORY WORK BEFORE STARTING INITIAL PLANTING OPERATIONS.		
ACCEPT ALL PLANT STOCK IN ACCORDANCE WITH MnDOT 3861 PRIOR TO PLANTING.		
THE CONTRACTOR WILL DEMONSTRATE COMPETENCY FOR SOIL CULTIVATION OPERATIONS IN ACCORDANCE WITH (MnDOT 2571.3D2 STEP 4)		
THE CONTRACTOR WILL DEMONSTRATE COMPETENCY FOR ALL PLANT INSTALLATION OPERATIONS IN ACCORDANCE WITH MnDOT 2571.3F1		
RODENT PROTECTION	NO RODENT PROTECTION IS REQUIRED.	
FERTILIZER	SEE SPECIAL PROVISIONS	
COMPOST	MnDOT 3890 GRADE 2 UNLESS OTHERWISE SPECIFIED.	
MULCH MATERIAL	MnDOT 3882 TYPE 6 UNLESS OTHERWISE SPECIFIED.	
MASS PLANTING BEDS	PREPARE MASS PLANTING BEDS FOR PLANTS PLACED AT 6' OR LESS, UNLESS OTHERWISE SPECIFIED ON SHEETS. PLANT BEDS IN STAGGERED ROWS ON THE PERIMETER FIRST, THEN UNIFORMLY FILL IN WITH REMAINING PLANTS. USE TRIANGULAR SPACING, UNLESS SPECIFIED OTHERWISE. PROVIDE 5' RADIUS CLEAR OF SHRUBS AROUND EACH DECIDUOUS TREE AND 8' CLEAR RADIUS AROUND EACH CONIFER TREE. RADIUS WILL BE MEASURED FROM THE CENTER OF THE TREE TO THE CENTER OF THE SHRUB. NOTIFY ENGINEER OF GROSS PLANT QUANTITY SURPLUS OR DEFICIENCY IMMEDIATELY. MULCH ENTIRE MASS PLANTING BED. SEE STANDARD PLANTING DETAILS.	
TREE PAINTING (FROST CRACK PREVENTION)	NO PAINTING OF TREE STEMS SHALL BE REQUIRED.	
PLANTING PLAN DIMENSIONS	STATED DIMENSIONS SUPERCEDE SCALING FROM PLAN.	
WATERING GUIDELINES (MnDOT 2571.3G)	PLANT TYPE	AVERAGE GALLONS OF WATER PER APPLICATION
	MACHINE TRANSPLANTED TREES	50-100
	BALLED AND BURLAPPED TREES	20
	BARE ROOT AND CONTAINER TREES	15
	BALLED AND BURLAPPED SHRUBS	10
	BARE ROOT AND CONTAINER SHRUBS	7
	WOODY SEEDLINGS	4
	PERENNIALS AND VINES	3
	IT IS THE CONTRACTOR'S RESPONSIBILITY TO MONITOR AND MAINTAIN SOIL MOISTURE AT ADEQUATE BUT NOT EXCESSIVE LEVELS. THE AMOUNTS LISTED ABOVE ARE GUIDELINES, NOT REQUIREMENTS.	

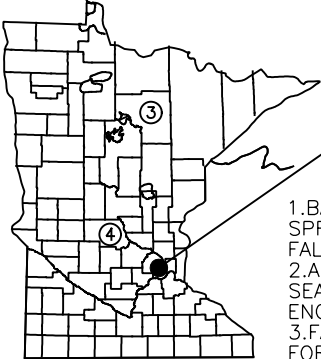

PROJECT LOCATION

- 1.BARE ROOT PERENNIALS MUST BE INSTALLED IN THE SPRING NO LATER THAN JUNE 1ST OR FOLLOW THE FALL DECIDUOUS PLANTING DATES.
- 2.ACTUAL DATES MAY CHANGE DEPENDING UPON SEASONAL CONDITIONS, AS DETERMINED BY THE ENGINEER.
- 3.FALL PLANTING IS NOT ALLOWED FOR BARE ROOT FORM OF THE FOLLOWING SPECIES: HAWTHORN, DOGWOOD, POPLAR, HACKBERRY, LINDEN, IRONWOOD, HONEYLOCUST, BIRCH, MOUNTAIN ASH, MAPLE, WILLOW, CRABAPPLE, PLUM/CHERRY, OAKS, AND SUMAC.
- 4.ALL REPLACEMENT PLANTS MUST BE INSTALLED DURING THE MONTH OF MAY DURING THE FIRST YEAR OF THE PLANT ESTABLISHMENT PERIOD.

PLANTING DATES BY ZONE						
KEY	SPRING				FALL	
	DECIDUOUS	CONIFEROUS	PERENNIALS	SEEDLINGS	DECIDUOUS	CONIFEROUS
③	APRIL 21 TO JUNE 1	APRIL 21 TO JUNE 1	MAY 1 TO JUNE 15	APRIL 21 TO JUNE 1	OCT. 1 TO NOV. 1	AUG. 25 TO SEPT. 15
④	APRIL 7 TO JUNE 1	APRIL 7 TO MAY 17	MAY 1 TO JUNE 15	APRIL 7 TO MAY 17	OCT. 10 TO NOV. 15	AUG. 25 TO SEPT. 15

PLANT INSTALLATION PERIOD

(MnDOT 2571.3F2)

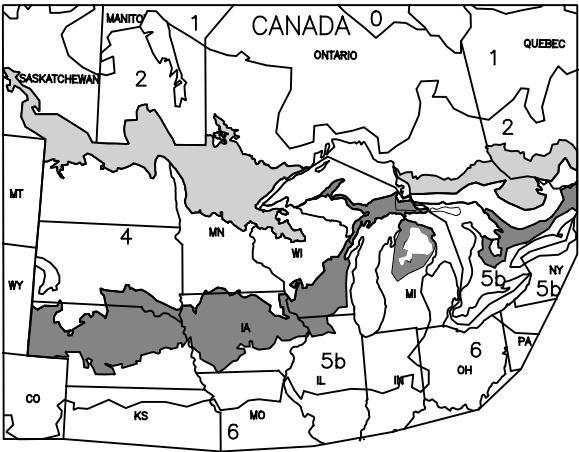

ACCEPTABLE ZONES		
ZONES	LEGEND	MIN. TEMP
3		-34.4° TO -40° F
4		-28.9° TO -34.4° F
5a		-28.1° TO -28.9° F

UNACCEPTABLE ZONES	
ZONES	LEGEND
0, 1, 2, 5b and 6	

FOR ALL PLANT STOCK, DOCUMENT ACCEPTABILITY FOR HARDINESS IN THE MINNESOTA ZONE WHERE THE PROJECT SITE IS LOCATED, AS FOLLOWS:

A.PLANT STOCK CONTINUOUSLY GROWN FOR AT LEAST THE LAST TWO YEARS WITHIN THE ACCEPTABLE LIMITS SHOWN.

OR

B.PLANT STOCK, GROWN OUTSIDE THE ACCEPTABLE GROWING RANGE LIMITS, HAVING SEED SOURCE OR ROOT AND GRAFT STOCK ORIGINATING FROM THE ACCEPTABLE LIMITS SHOWN.

ACCEPTABLE PLANT STOCK GROWING RANGE LIMITS

SOURCE: USDA PLANT HARDINESS ZONE MAP (MnDOT 3861.2C)

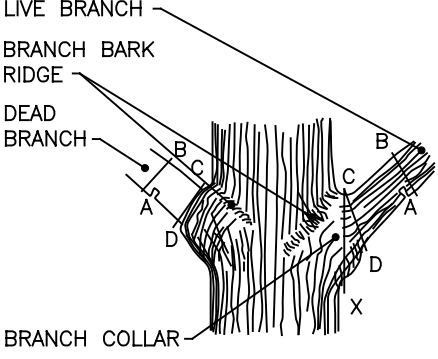

BRANCHES PRUNED AT TRUNK (SHIGO METHOD)

- STEPS TO PRUNING WITH PRUNING SAW:
- 1.CUT PART WAY THROUGH THE BRANCH AT POINT A.
 - 2.CUT COMPLETELY THROUGH BRANCH FROM POINT B TO A.
 - 3.AT BRANCH COLLAR CUT FROM POINT C TO D.

INCORRECT CUT FROM POINT C TO X (TOO CLOSE) WILL RESULT IN DISCONTINUOUS CALLUS FORMATION AFTER ONE SEASON OF GROWTH.

CORRECT CUT FROM POINT C TO D (LEAVING BRANCH COLLAR BUT NOT THE STUB FROM POINT B TO A) WILL RESULT IN CONTINUOUS DOUGHNUT SHAPED CALLUS FORMATION AFTER ONE SEASON OF GROWTH.

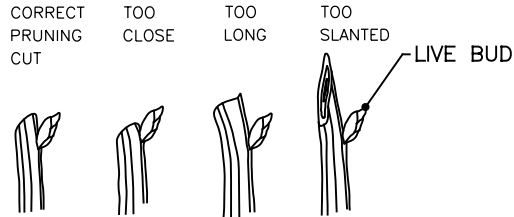

BRANCHES PRUNED TO LIVE BUD

PRUNING

- PRUNING NOTES:
- 1.PRUNE USING CLEAN AND SHARP SCISSOR-TYPE PRUNER OR PRUNING SAW.
 - 2.THE BEST TIME TO PRUNE IS LATE DORMANT SEASON OR EARLY SPRING.
 - 3.AVOID PRUNING OAKS IN APRIL, MAY, JUNE OR JULY.
 - 4.IF PRUNING IS NECESSARY OR IF WOUNDS OCCUR TO OAK TREES IN APRIL, MAY, JUNE OR JULY, IMMEDIATELY PAINT CUT SURFACE OR WOUND WITH LATEX PAINT OR SHELLAC.

(MnDOT 2571.3K2a9 and 2571.3E1)

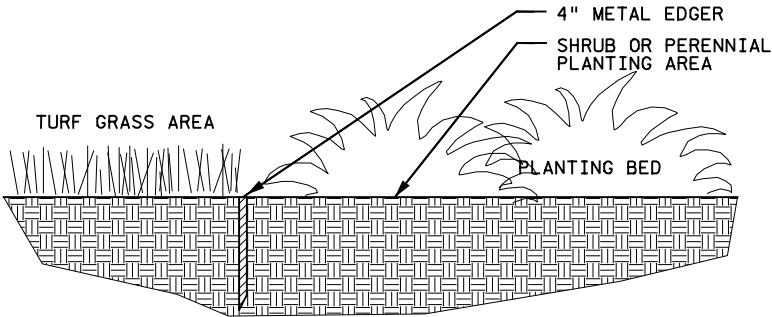

METAL LANDSCAPE EDGER

NOT TO SCALE

NO.	DATE	DRW	CKD	APP	REVISION

I HEREBY CERTIFY THAT THIS PLAN, SPECIFICATION, OR REPORT WAS PREPARED BY ME OR UNDER MY DIRECT SUPERVISION AND THAT I AM A DULY LICENSED PROFESSIONAL LANDSCAPE ARCHITECT UNDER THE LAWS OF THE STATE OF MINNESOTA.

SEAN C. JERGENS

47256 1/14/2020
LIC. NO. DATE



Minneapolis
Public Works

LANDSCAPING DETAILS

DRW: SCJ	DATE: 12/18/19
CHK: RB	DATE: 1/14/2020
APP: SCJ	DATE: 1/14/2020

HOYER HEIGHTS RECONSTRUCTION

LP 600D2317 LP 600D4569

PLANTING HOLE DIMENSIONS			
HOLE DEPTH FOR B&B AND CONTAINER PLANTS SHALL NOT EXCEED MEASUREMENT FROM ROOT FLAIR TO BOTTOM OF SOIL BALL.			
PLANT TYPE	PLANT SIZE UP TO AND INCLUDING	(A) MINIMUM HOLE WIDTH	(B) APPROXIMATE HOLE DEPTH
DECIDUOUS & ORNAMENTAL TREES	3' B.R.	46"	13"
	4' B.R.	46"	14"
	5' B.R.	48"	14"
	6' B.R.	54"	15"
	7' B.R.	60"	16"
	8' B.R.	66"	19"
	0.75' B.R.	48"	12"
	1" B.R.	54"	14"
	1.25" B.R.	60"	15"
	1.5" B.R.	66"	16"
	1.75" B.R.	72"	19"
	2" B.R.	84"	19"
	4' B.B.	42"	11"
	5' B.B.	48"	12"
	6' B.B.	52"	14"
	8' B.B.	66"	16"
	10' B.B.	66"	16"
	12' B.B.	48"	16"
	1" B.B.	54"	14"
	1.25" B.B.	56"	15"
	1.5" B.B.	61"	15"
	1.75" B.B.	66"	16"
	2" B.B.	72"	16"
	2.5" B.B.	84"	19"
	3" B.B.	96"	20"
	3.5" B.B.	114"	23"
	4" B.B.	126"	25"
DECIDUOUS SHRUBS, ROSES AND PERENNIALS	12" B.R.	24"	7"
	15" B.R.	28"	8"
	18" B.R.	30"	8"
	2' B.R.	33"	9"
	3' B.R.	42"	11"
	4' B.B.	48"	12"
PERENNIAL HOLE DEPTH AND WIDTH SHALL BE BASED UPON ON-CENTER SPACING IN A CONTINUOUS TRENCH.	5' B.R.	54"	14"
	6' B.R.	60"	14"
	18" B.B.	27"	7"
	2' B.B.	30"	8"
	3' B.B.	36"	9"
	4' B.B.	42"	11"
	5' B.B.	48"	12"
	6' B.B.	54"	14"

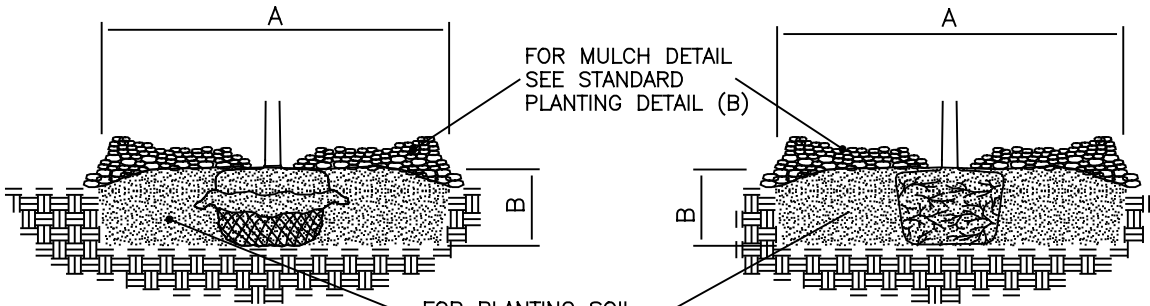

- 1.SCARIFY SIDES AND BOTTOM OF HOLE.
- 2.PROCEED WITH CORRECTIVE PRUNING.
- 3.SET PLANT ON UNDISTURBED NATIVE SOIL OR THOROUGHLY COMPACTED PLANTING SOIL. INSTALL PLANT SO THE ROOT FLARE IS AT OR UP TO 2" ABOVE THE FINISHED GRADE WITH BURLAP AND WIRE BASKET, (IF USED), INTACT.
- 4.SLIT REMAINING TREATED BURLAP AT 6" INTERVALS.
- 5.BACKFILL TO WITHIN APPROXIMATELY 12" OF THE TOP OF THE ROOTBALL, THEN WATER PLANT.
- 6.REMOVE THE TOP 1/3 OF THE BASKET OR THE TOP TWO HORIZONTAL RINGS WHICHEVER IS GREATER. REMOVE ALL BURLAP AND NAILS FROM THE TOP 1/3 OF THE BALL. REMOVE ALL TWINE. REMOVE OR CORRECT STEM GIRDLING ROOTS.
- 7.PLUMB AND BACKFILL WITH PLANTING SOIL.
- 8.WATER THOROUGHLY WITHIN 2 HOURS TO SETTLE PLANTS AND FILL VOIDS.
- 9.BACK FILL VOIDS AND WATER A SECOND TIME.
- 10.PLACE MULCH WITHIN 48 HOURS OF THE SECOND WATERING UNLESS SOIL MOISTURE IS EXCESSIVE.

- 1.SCARIFY SIDES AND BOTTOM OF HOLE.
- 2.PROCEED WITH CORRECTIVE PRUNING OF TOP AND ROOT.
- 3.REMOVE CONTAINER AND SCORE OUTSIDE OF SOIL MASS TO REDIRECT AND PREVENT CIRCLING FIBROUS ROOTS. REMOVE OR CORRECT STEM GIRDLING ROOTS.
- 4.SET PLANT ON UNDISTURBED NATIVE SOIL OR THOROUGHLY COMPACTED PLANTING SOIL. INSTALL PLANT SO THE TOP OF THE ROOT FLARE IS AT OR UP TO 2" ABOVE THE FINISHED GRADE.
- 5.PLUMB AND BACKFILL WITH PLANTING SOIL.
- 6.WATER THOROUGHLY WITHIN 2 HOURS TO SETTLE PLANT AND FILL VOIDS.
- 7.BACK FILL VOIDS AND WATER A SECOND TIME.
- 8.PLACE MULCH WITHIN 48 HOURS OF THE SECOND WATERING UNLESS SOIL MOISTURE IS EXCESSIVE.

CONTAINER STOCK

BALLED & BURLAPPED STOCK

INSTALLATION OF PLANTS

(MnDOT 2571.3F)

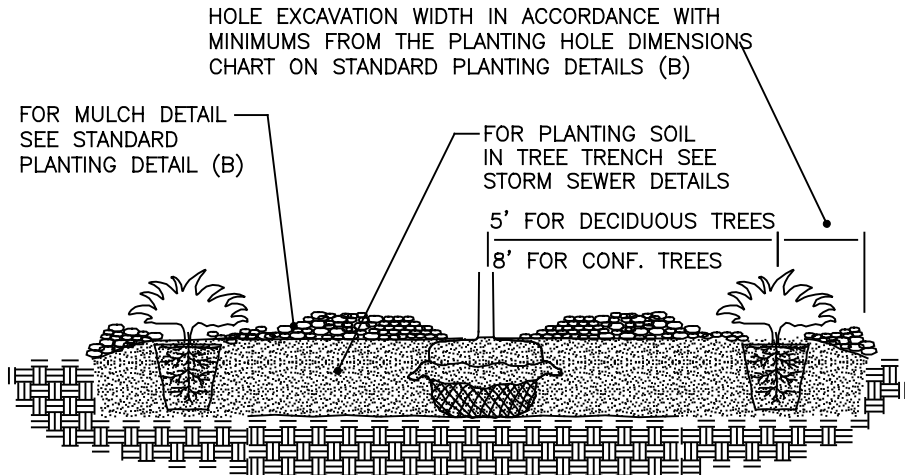

PLANT SPACING IN MASS BEDS

PLANTING HOLE DIMENSIONS			
HOLE DEPTH FOR B&B AND CONTAINER PLANTS SHALL NOT EXCEED MEASUREMENT FROM ROOT FLAIR TO BOTTOM OF SOIL BALL.			
PLANT TYPE	PLANT SIZE UP TO AND INCLUDING	(A) MINIMUM HOLE WIDTH	(B) APPROXIMATE HOLE DEPTH
CONIFEROUS TREES	2' B.B.	36"	10"
	3' B.B.	42"	11"
	4' B.B.	51"	13"
	5' B.B.	60"	13"
	6' B.B.	66"	15"
	7' B.B.	72"	16"
	8' B.B.	81"	18"
	9' B.B.	90"	20"
	10' B.B.	102"	21"
	12' B.B.	114"	24"
	18" B.B.	24"	7"
	3' B.B.	48"	12"
CONIFEROUS SHRUBS (UPRIGHT)	18" SPR B.B.	30"	8"
CONIFEROUS SHRUBS (SPREADING)	2' SPR B.B.	36"	9"
CONTAINER GROWN PLANTS	CELLPACKS / PLUGS	6"	2.5"
	2.25" CONT.	7"	3"
	3.5" CONT.	10"	3"
	4" CONT.	11"	4"
	4.5" CONT.	13"	4"
	6" / 1 QT CONT.	15"	5.5"
	1# CONT.	18"	6"
	2# CONT.	23"	7.5"
	3# CONT.	29"	8.5"
	5# CONT.	30"	11"
	7# CONT.	37"	11"
	15# CONT.	44"	14"
	10# CONT.	45"	15"
	20# CONT.	60"	16"
	25# CONT.	72"	17"
SEEDLINGS	6" SEEDLING	15"	14"
	9" SEEDLING	18"	14"
	12" SEEDLING	23"	16"
	18" SEEDLING	30"	16"
	2' SEEDLING	36"	18"
VINES	1 YR. MED B.R.	15"	11"
	1 YR. NO. 1 B.R.	17"	14"
	2 YR. MED. B.R.	33"	12"
	2 YR. NO. 1 B.R.	42"	15"

MULCH AREA CALCULATOR

TYPE OF PLANT	SQ. FT. PER PLANT
CONIFEROUS TREES	$\left(\left(\frac{3}{2} \times \text{HEIGHT}\right)^2 + 3\right) \times \pi$
DECIDUOUS AND ORNAMENTAL TREES	$3^2 \times \pi$
CONIFEROUS AND DECIDUOUS SHRUBS, ROSE BUSHES, PERENNIALS, ORNAMENTAL GRASS	SPACING x SPACING
VINES	SPACING x 2
MACHINE-MOVED TREES OR SHRUBS	$\left(\left(\frac{\text{SPADE DIAMETER}}{2}\right)^2 + 1\right) \times \pi$

$\pi = 3.1416$

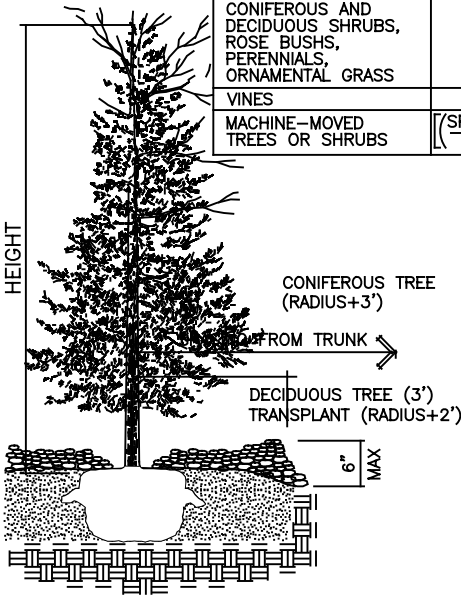

- 1.PULL MULCH BACK NO LESS THAN 3" AND NO MORE THAN 6" FROM TREES AND SHRUBS AT THE TRUNK OR MAIN STEM.
- 2.SUBSIDING OR DETERIORATING MULCH IS ACCEPTABLE THROUGHOUT THE ESTABLISHED PERIOD IF THE MULCH DEPTH IS MAINTAINED AT A MINIMUM 3" DEPTH.
- 3.ADD MULCH WHEN BELOW THE 3" MINIMUM DEPTH, DO NOT EXCEED THE 6" MAXIMUM DEPTH.
- 4.MULCH CONTAMINATED WITH SOIL MUST BE REMOVED AND REPLACED.

MULCH PLACEMENT

(MnDOT 2571.3H)

NO.	DATE	DRW	CKD	APP	REVISION

I HEREBY CERTIFY THAT THIS PLAN, SPECIFICATION, OR REPORT WAS PREPARED BY ME OR UNDER MY DIRECT SUPERVISION AND THAT I AM A DULY LICENSED PROFESSIONAL LANDSCAPE ARCHITECT UNDER THE LAWS OF THE STATE OF MINNESOTA.

Sean C. Jergens

SEAN C. JERGENS

47256 1/14/2020

LIC. NO. DATE



LANDSCAPING DETAILS

DRW: SCJ	DATE: 12/18/19
CHK: RB	DATE: 1/14/2020
APP: SCJ	DATE: 1/14/2020

HOYER HEIGHTS RECONSTRUCTION

LP 600D2317 LP 600D4569

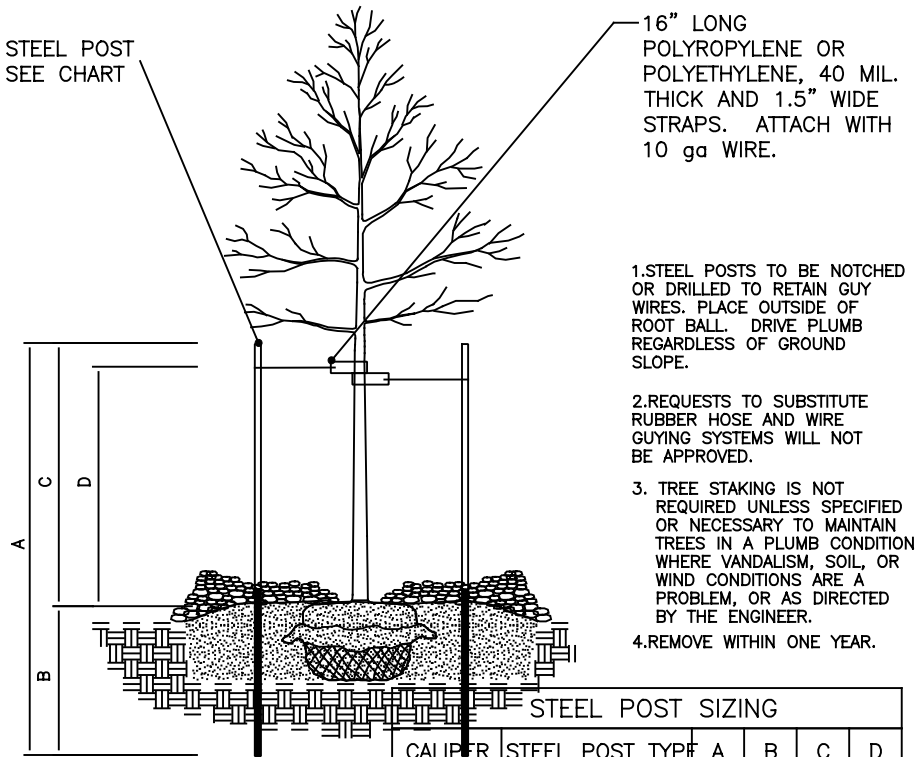

STAKING AND GUYING

(MnDOT 2571.311)

STEEL POST SIZING					
CALIPER	STEEL POST TYPE	A	B	C	D
LESS THEN 4 INCHES	ROLLED STEEL FENCE POST (MnDOT 3403) OR APPROVED EQUAL.	7'-0"	3'-0" MIN.	4'-0"	3'-0"
GREATER THEN 4 INCHES	10', 2.2 LB. FLANGED CHANNEL STEEL SIGN POST (MnDOT 3401) OR APPROVED EQUAL.	10'-0"	4'-0" MIN.	6'-0"	5'-0"

PLANT SCHEDULE

QTY	SYMBOL	BOTANICAL NAME	SIZE	ROOT	REMARKS
DECIDUOUS TREES (21)					
2	BTU	<i>Nyssa sylvatica</i> BLACK TUPELO	2.5" CAL.	B&B	Single, straight leader
3	ELM	<i>Ulmus americana</i> 'Princeton' ST. CROIX ELM	2.5" CAL.	B&B	Single, straight leader
4	HB	<i>Celtis occidentalis</i> COMMON HACKBERRY	2.5" CAL.	B&B	Single, straight leader
3	LPT	<i>Platanus</i> # <i>acerifolia</i> LONDON PLANE TREE	2.5" CAL.	B&B	Single, straight leader
3	RSM	<i>Acer rubrum</i> 'Franks Red' RED SUNSET MAPLE	2.5" CAL.	B&B	Single, straight leader
6	SWO	<i>Quercus bicolor</i> SWAMP WHITE OAK	2.5" CAL.	B&B	Single, straight leader
PERENNIALS					SPACING
#1 CONTAINER GRASSES, SEDGES, AND FORBS					
188	BAB	<i>Bouteloua gracilis</i> 'Blonde Ambition' BLONDE AMBITION BUFFALO GRASS	#1	CONT	24" ON CENTER
245	BES	<i>Rudbeckia</i> 'Goldsturm' GOLDSTURM BLACK EYED SUSAN	#1	CONT	24" ON CENTER
97	BFM	<i>Asclepias tuberosa</i> BUTTERFLY MILKWEED	#1	CONT	24" ON CENTER
220	HLB	<i>Schizachyrium scoparium</i> 'MinnBlue A' HEAVEN LITTLE BLUESTEM	#1	CONT	24" ON CENTER
34	ING	<i>Sorghastrum nutans</i> 'Indian Steel' INDIAN STEEL' INDIAN GRASS	#1	CONT	24" ON CENTER
225	IRI	<i>Iris versicolor</i> BLUE FLAG IRIS	#1	CONT	24" ON CENTER
74	JPW	<i>Eupatorium maculatum</i> 'Phantom' PHANTOM JOE PYE WEED	#1	CONT	24" ON CENTER
142	KBS	<i>Liatris spicata</i> 'Kobold' KOBOLD BLAZINGSTAR	#1	CONT	24" ON CENTER
228	PCF	<i>Echinacea</i> 'Pixie Meadowbrite' PIXIE MEADOWBRITE PURPLE CONEFLOWER	#1	CONT	24" ON CENTER
730	PDS	<i>Sporobolus heterolepis</i> 'Tara' TARA' PRAIRIE DROPSEED GRASS	#1	CONT	24" ON CENTER
122	MON	<i>Monarda</i> 'Grand Parade' GRAND PARADE' MONARDA	#1	CONT	24" ON CENTER
4" CONTAINER GRASSES, SEDGES, AND FORBS					SPACING
345	BLS	<i>Liatris spicata</i> BLAZINGSTAR	4"	CONT	12" ON CENTER
387	CAN	<i>Anemone canadensis</i> CANADA ANEMONE	4"	CONT	12" ON CENTER
345	COR	<i>Coreopsis lanceolata</i> LANCE-LEAVED COREOPSIS	4"	CONT	12" ON CENTER
466	FXS	<i>Carex vulpinoidea</i> FOX SEDGE	4"	CONT	12" ON CENTER
226	LLB	<i>Houstonia longifolia</i> LONG LEAF BLUET	4"	CONT	12" ON CENTER
345	PAR	<i>Juncus tenuis</i> PATH RUSH	4"	CONT	12" ON CENTER
226	PPC	<i>Dalea purpurea</i> PURPLE PRAIRIE CLOVER	4"	CONT	12" ON CENTER

6:00:01 PM

DATE PRINTED = 1/16/2020

FILE NAME = ...[FinalPlan\12067_in12.dgn

NO.	DATE	DRW	CKD	APP	REVISION

I HEREBY CERTIFY THAT THIS PLAN, SPECIFICATION, OR REPORT WAS PREPARED BY ME OR UNDER MY DIRECT SUPERVISION AND THAT I AM A DULY LICENSED PROFESSIONAL LANDSCAPE ARCHITECT UNDER THE LAWS OF THE STATE OF MINNESOTA.

Sean C. Jergens
SEAN C. JERGENS

47256 1/14/2020
LIC. NO. DATE



LANDSCAPING DETAILS

DRW: SCJ	DATE: 12/18/19
CHK: RB	DATE: 1/14/2020
APP: SCJ	DATE: 1/14/2020

HOYER HEIGHTS RECONSTRUCTION

LP 600D2317 LP 600D4569